



BLOCK X750 HDPE

PRE-APPLIED HDPE WATERPROOFING MEMBRANE (SANDED)

TECHNICAL SHEET 03/04/2023

SMART ADVANTAGES

- Form an integral seal to poured concrete, prevent lateral water migration.
- Fully bonded watertight selvedge laps and detailing.
- Easy to install, does not require primer
- Unaffected by hydrostatic pressure
- Unaffected by contamination
- Can repair slight construction injury
- Integration of self-adhesion, waterproof and protection, so that can reduce construction links
- One layer can reach level one waterproofing security requirements

DESCRIPTION

BLOCK X750 HDPE is a multilayer compound waterproof material with excellent performance. It includes one layer of high density PE film, one layer pressure sensitive polymer adhesive and one insulation layer. It is widely used on flat concrete surface as well as waterproof layer of vertical surface of temporary and adjacent structures to form continuous and permanent combination.

FUNCTIONAL CHARACTERISTICS

BLOCK X750 HDPE is designed for waterproofing protection to basement with accessible and non-accessible basements rafts and confined retaining walls with high water table and cut & cover structures area such as tunnels, subway and etc.

COVERAGE

Width 2 meter, Length 20 meters (40sqms coverage) with a pre-stripped 75mm side lap adhesive.

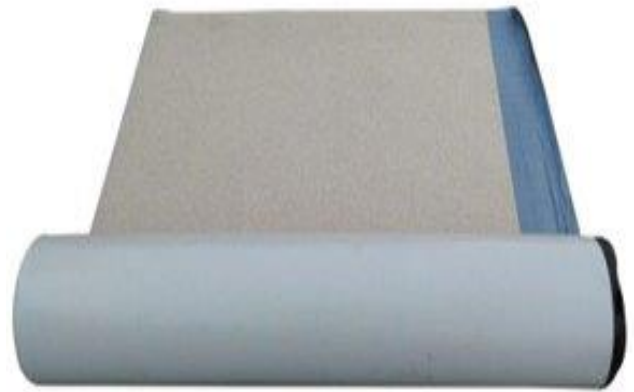

TECHNICAL CHARACTERISTICS

Color	White
Tensile strength (ASTM D412)	22 +/-5 MPa
Elongation at break (ASTM D412)	≥550%
Puncture Resistance (ASTM E154)	≥600 N
Performance of anti-water breakthrough	0.6 MPa, no water breakthrough
Low Temperature Flexibility (ASTM D1970M-15)	<-25 degrees C (no visual cracks)
Peel Adhesion to Concrete (ASTM D903-98)	≥880 N/mm
Peeling strength with post-cast concrete after immersed in water	≥1.5 N/mm

APPLICATION

SUBSTRATE PREPARATION

Substrate must be a sound and solid substrate to prevent movement during the concrete pouring. Substrates must be regular and smooth with no protrusion or voids.

Horizontal surface – the sub-base must be free of loose aggregate, voids, surface irregularities and sharp protrusions. The surface needs to be in a dry condition and no standing water.

Vertical Surfaces – the vertical surfaces should have proper levelled permanent formwork, concrete skin, brickwork, blockwork or temporary formwork for accessible area without any irregularities. For the case of sheet piles, the substrate should be made regular to profile with a smooth finished and details.

APPLICATION

FIXING: Fully bonded **BLOCK X750 HDPE** membrane are supplied with a selvedge on one side to provide self-adhered laps for continuity between rolls. Unroll the **BLOCK X750 HDPE** with white HDPE film side to the substrate. End laps should be staggered to avoid build-up of layers. Leave the plastic release liner intact until overlap procedure is completed. Ensure the underside of membrane is clean and free from contamination before removing the plastic release liner between the overlaps. Ensure a continuous bond is achieved without creases and use press roller to smoothen the overlap surface. The non-selvedge laps can be bonded with **BLOCK X752 HDPE TWO SIDE TAPE**. Care should be taken to avoid any damage to the membrane during laying steel reinforcement, consolidation and compaction of concrete.

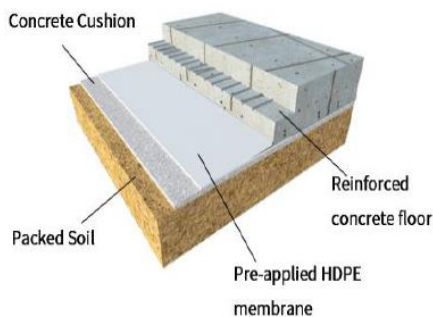

For the **vertical blinding** application, the **BLOCK X750 HDPE** membrane is mechanically fastened using flat-headed fixings appropriate to the substrate. Secure the top of the membrane using a batten or fixing 50mm below the top edge. Use fixings at typically 600mm centers to secure the membrane flat against the substrate.

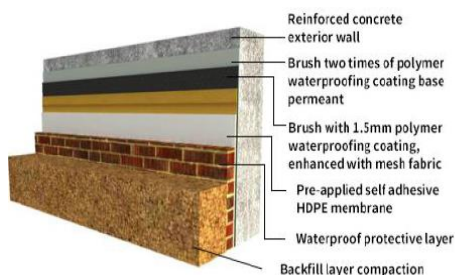

Overlaps all roll ends and cut edges by minimum of 75mm and ensure the area is clean and free from contamination, wiping with damp cloth if necessary. Allow the area to dry and apply the **BLOCK X752 HDPE TWO SIDE TAPE**. Ensure a continuous bond is achieved without creases and then roll or press down firmly.

Termination and damage repair can be done using **BLOCK X751 HDPE ONE SIDE TAPE**. Rectify the area of damage and repaired with an oversize cut of the **BLOCK X751 HDPE ONE SIDE TAPE**.

Pouring of Concrete is recommended that concrete is poured within 35 days after the membrane has been laid on the sub-base (e.g. PCC).

CURING:

No curing is required.

CLEANING

BLOCK X750 HDPE membrane can be cleaned with cleaning solvents before repairing the damage area.

STORAGE & SHELF LIFE

The shelf life of **BLOCK X750 HDPE** is 12 months from the date of manufacturing.

Moving, transporting, storing and using materials should avoid objects and environments that easily cause perforation or physical damage.

Different types of products should be classified and stored in parallel, with a height of no more than 5 layers.

The finished products should be sealed and packed using clean waterproof cloth to protect and put it in a high place, such as pallet or wood.

PACKAGING

BLOCK X750 HDPE 2mx20mx1.2mm per roll
BLOCK X751 HDPE ONE SIDE TAPE 10cmx20m per roll
BLOCK X752 HDPE TWO SIDE TAPE 10cmx25m per roll

HEALTH AND SAFETY

Suitable protection clothing, dust masks, gloves and eye protection should be worn during membrane installation.

For more detailed information refer to Safety Data Sheet.

DISCLAIMER

Bostik offers this Technical Data Sheet ("TDS") for descriptive and informational use only. It is not a warranty, a contract or a substitute for expert or professional advice. Please also see the local product Safety Data Sheet for health and safety considerations.

The statements, technical information, data, and recommendations contained in this TDS are provided 'AS IS' and are not warranted or guaranteed in any way. They represent typical results for the products and are based on Bostik's research only. Since the conditions and methods of use of the products are beyond our control, Bostik expressly disclaims any and all liability and damages of whatever kind or nature that may arise from any use of the products, the results therefrom, or reliance on the information contain herein.

Bostik Philippines, Inc.

35/F Raffles Corporate Center, F. Ortigas Jr. Road,
 Ortigas Business Center, Pasig City 1600, Philippines
 Phone: +632 7900-5656 | +632 7900-5633
www.bostik.com

BOSTIK HOTLINE

Smart help +632 7900-5656

