

Impregnated fibreboard filler

Uses

Flexcell is a compressible, non-extruding, bitumen impregnated, fibreboard expansion joint filler suitable for forming joints between in-situ and precast concrete components. Forming structural expansion and separation joints in:

- Concrete pavements and floors
- Roads, ramps and runways
- Pedestrian areas
- Concrete retaining walls and bridges
- Concrete basement structures and subways

Advantages

- Easy to handle, cut and paste
- Resilient
- Will not extrude under compression

Standards compliance

DTp Specification for Highway Works, Dec 1991 series 1000 clause 1015. PSA standard specification clauses for airfield pavement works. American Association of State Highway Officials, Standard Specification M 153-54. US Federal Specification HH-F-341a: Type 1, Class B.

Description

Flexcell is a compressible joint filler manufactured from bitumen impregnated wood fibres. It is supplied in sheet form and is used to form and fill expansion joints in in-situ and pre-cast concrete construction.

Design criteria

Typical sealed expansion joints in roads, runways and other trafficked surfaces

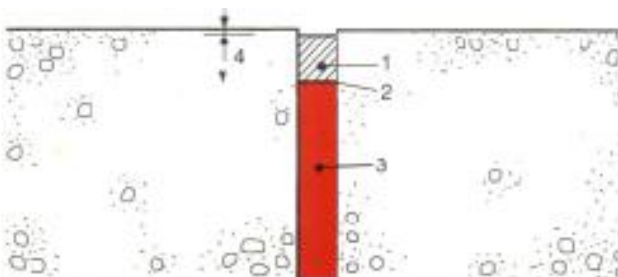

1. Pliastic or Colpor 200
2. Polyethylene bond breaker tape (Colpor 200)
3. Flexcell
4. Recessed seal

Example of a sealed subway expansion joint is shown below

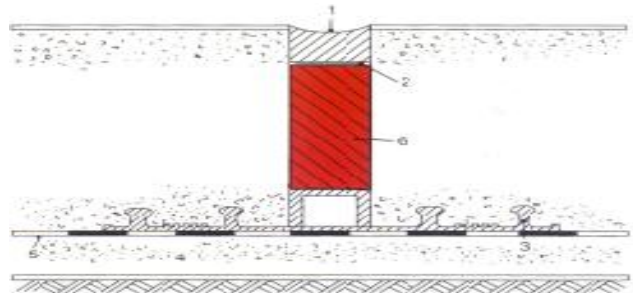

1. Thioflex 600
2. Bond breaking tape
3. Supercast Rearguard 'S' waterstop
4. Blinding concrete
5. Famflex membrane
6. Flexcell

Properties

Form	:	Compressible sheet
Solids content	:	100%
Recovery	:	Greater than 70%
Weathering test	:	No disintegration

Specification clauses

The expansion joint filler as detailed shall be genuine Flexcell supplied by Fosroc and installed strictly in accordance with the relevant Fosroc data sheet.

Application instructions

Slabs

Where used to form an expansion joint in in-situ concrete, Flexcell shall be placed against the shuttering on the concreting side before the pour begins. Copper nails may be used to prevent displacement in joints in suspended slabs.

Flexcell

Alternatively, Flexcell may be bonded to the existing slab or previous pour using a suitable adhesive such as Plastiseal or Supastik wall panel adhesive. Care should be taken not to contaminate surfaces of the sealing slot with the adhesive.

Where a sealed joint is not required e.g. soffit joints or in retaining walls, Flexcell may be installed in conjunction with Fosroc PVC Capping Strip.

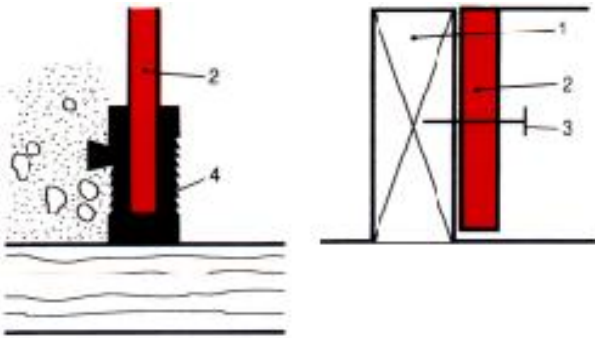

1. Shuttering
2. Flexcell
3. Copper nails
4. Fosroc PVC Capping Strip

A joint sealing slot can be formed by placing a removable timber former on top of the Flexcell.

Alternatively, Flexcell can Joint sealing be installed to the full depth of the slab and cut back to the required depth subsequently using a power brush machine. This latter method is generally used for housing estate roads, which cannot be cleaned and sealed until all building has finished. Flexcell should be tamped down to ensure that it fills the joint completely and provides continuous support for the joint sealant.

Estimating

Nominal sheet thickness	:	10 mm
		12.5 mm
		20 mm
		25 mm
Sheet sizes	:	1.22 m x 2.14 m
Sheet weights	:	12.5 mm 20 mm 25 mm
		12.4 kg 19.8 kg 24.75 kg

Storage

As with all organic materials there is a very slight risk of spontaneous combustion if stored long term in wet conditions.

Precautions

There are no health hazards associated with Flexcell in normal use

Additional information

As well as joint sealants and ancillary products, Fosroc also manufactures a wide range of complementary products, which includes waterstops, waterproofing membranes, grouts, anchors and specialised flooring materials.

In addition, a wide range of products specifically designed for the repair and refurbishment of damaged reinforced concrete are available. This includes hand-placed and spray grade repair mortars, fluid micro-concretes, chemical-resistant epoxy mortars and a comprehensive package of protective coatings.



Fosroc Sdn. Bhd.

No 8 Jalan Trompet, 33/8
Seksyen 33, 40400 Shah Alam
Selangor, Malaysia.

Branch Office:

29, Jalan Zainal Abidin,
10400 Penang, Malaysia.

www.fosroc.com

Important note

Fosroc products are guaranteed against defective materials and manufacture and are sold subject to its standard Conditions for the Supply of Goods and Services, copies of which may be obtained on request. Whilst Fosroc endeavours to ensure that any advice, recommendation, specification of information it may give is accurate and correct, it cannot, because it has no direct or continuous control over where or how its products are applied, accept any liability either directly or indirectly arising from the use of its products, whether or not in accordance with any advice, specification, recommendation of information given by it.

telephone:
+60 3 5191 5660

+60 4 2287 464

fax:
+60 3 5191 6960

+60 4 2292 661

email:
malaysia@fosroc.com

